

FOR LEASE

329 New Brunswick Ave. Rahway, NJ

\$10.00 Gross



Multiple spaces available
20' Ceiling height
Each space has separate loading
and utilities

Option to combine spaces
Gross Building Area: +/- 212,339
Zoning: I-H Heavy Industrial Zone

- Space A-8,956 SF--Rented
- Space B-20,985 SF -Rented
- Space C-7,706 SF
- Space D-10,274 SF -Rented
- Space E-37,904 SF
- Space F & G-21,809 SF
- Space H-48,713 SF
- Space I-7,236 SF -Rented
- Space J-19,713 SF
- Space K-5,531 SF
- Space L-16,371 SF -Rented

For additional information 1-800-732-4035:

Shaya Grosinger

(917)359-5727

shaya@gramercynj.com

Zev Steinmetz

(718)807-7016

zev@gramercynj.com



Gramercy Real Estate Services, LLC

25 Commerce Rd. Suite 370, Cranford, NJ 08016



The information contained herein has been obtained from sources considered to be reliable, but no guarantee of its accuracy is made by this company. In addition, no representation is made respecting zoning, condition of title, measurements, dimensions, or any matters of a legal or environmental nature. Such matters should be referred to legal counsel for determination. This correspondence is subject to errors, omissions, updates or withdrawal without prior notice.

329 New Brunswick Ave. Rahway, NJ

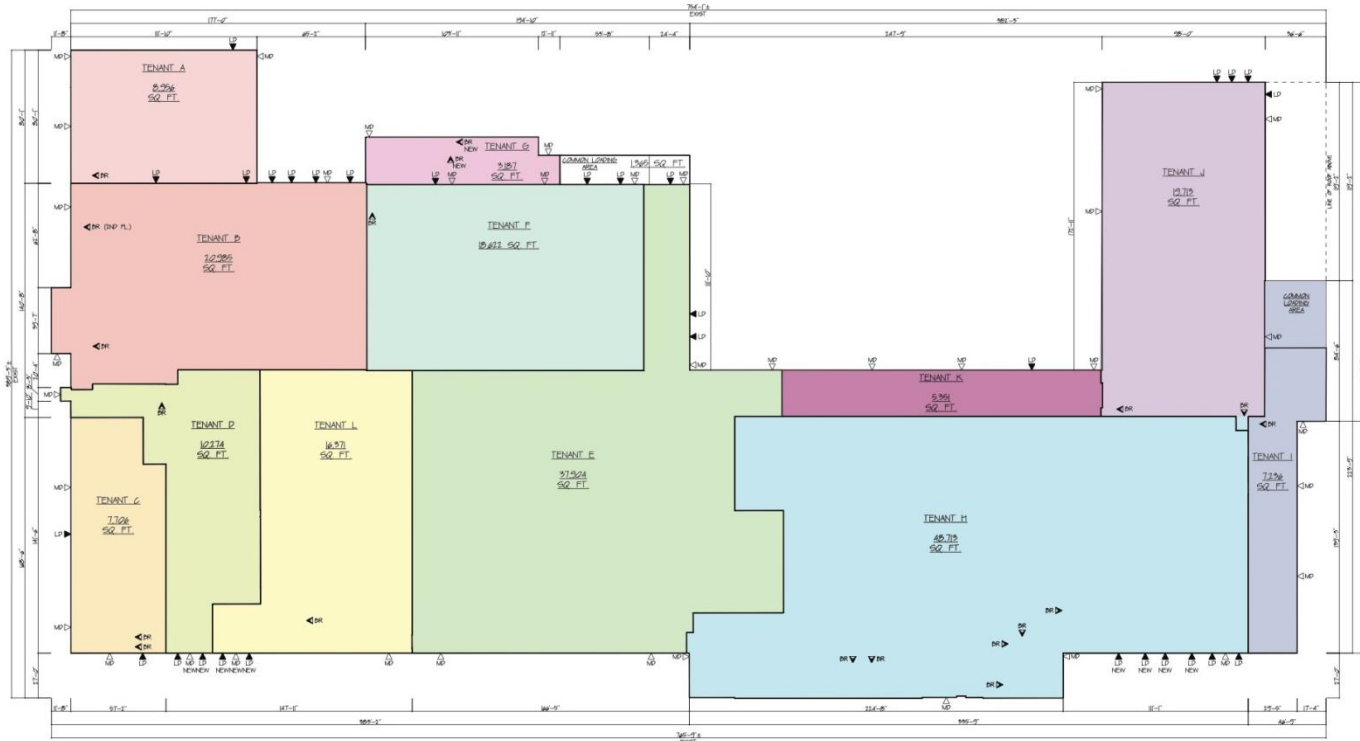

PROPOSED RECONFIGURATION
SCALE 1/4" = 1'-0"

- | | | | | |
|--|--|--|--|----------------|
| TENANT A
8,756 SQ. FT. | TENANT D
12,214 SQ. FT. | TENANT G
3,287 SQ. FT. | TENANT J
13,719 SQ. FT. | ▲ LOADING DOOR |
| TENANT B
22,085 SQ. FT. | TENANT E
16,971 SQ. FT. | TENANT H
34,812 SQ. FT. | TENANT K
5,351 SQ. FT. | ○ MAN-DOOR |
| TENANT C
7,708 SQ. FT. | TENANT F
19,812 SQ. FT. | TENANT I
45,719 SQ. FT. | TENANT L
16,971 SQ. FT. | ▲ BATHROOM |

329 New Brunswick Ave. Rahway, NJ



Gramercy Real Estate Services, LLC

25 Commerce Rd. Suite 370, Cranford, NJ 08016



329 New Brunswick Ave. Rahway, NJ



Gramercy Real Estate Services, LLC

25 Commerce Rd. Suite 370, Cranford, NJ 08016

